

Pneumatic Servo-cylinder, type RGE 100/60

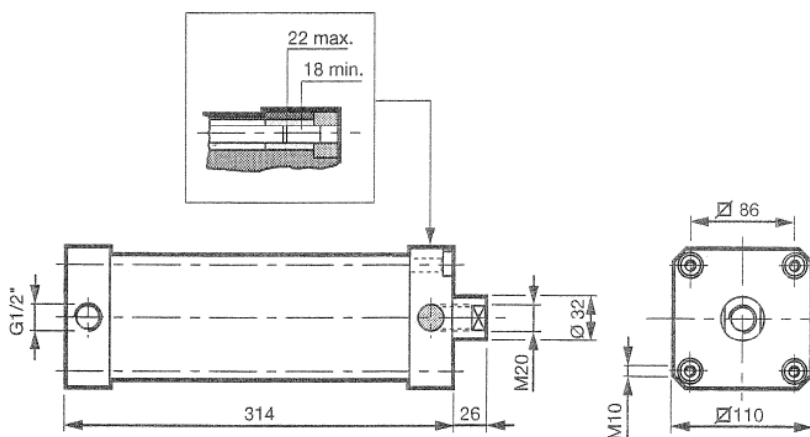
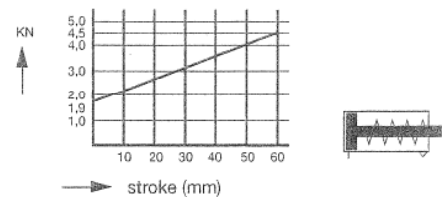
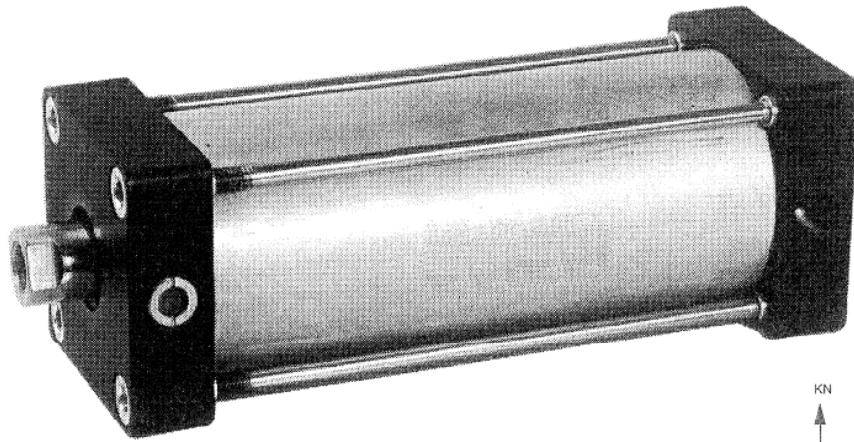

Function

Depending on the control pressure applied, this servo-cylinder will assume a position intermediate between the min. and max. values. Suitable for applications where small adjustment forces are necessary.

Applications

In general this servo-cylinder can be used for continuous remote control of various adjustment devices, e.g. in ships for the remote control of diesel engines, adjustable propellers and winches, and in the chemical industry for remote control of pumps and control valves:

- adjusting speed of main and auxiliary engines;
- adjusting clutches and brakes of winches for hoisting, anchoring and hauling;
- adjusting control valves, hydraulic pumps and hydraulic motors.

Technical data

- Bore : \varnothing 100 mm
- Stroke : 60 mm
- Medium : compressed air, filtered to min. 50 μ , lubricated or not lubricated.
- Pressure range : approximately 3 – 7 bar
- Connections : G 1/2
- Temp. range : -20° up to +70° Celsius
- Way of ordering : **RGE 100/60**