

## Lever operated electric controller, type Servo G

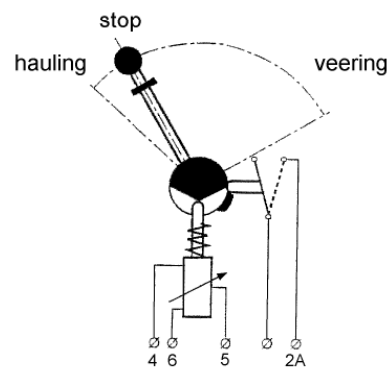

### Function

- By turning a lever out of the neutral "stop"-position:
- In one direction a potentiometer is infinitely adjusted and with that an electric voltage or current.
  - In the other direction a micro switch is operated after unlocking the lever.

### Applications

Remote control of brakes and clutches of winches for hoisting, hauling and fishing

### Construction:

The controller consists of a construction suitable for panel mounting:

- With at one side, after building in visible, a rotatable lever and a cover with illuminated indication of the lever position.
- With at the other side, yet to build in, a potentiometer, a micro switch and a connection terminal block. With the lever, internal cams are rotated through which the potentiometer and the micro switch are operated.

An adjustable brake is used to maintain the adjusted lever position after releasing.

### Operation

In one direction, the lever of the controller can be freely turned out of the neutral "stop"-position over the whole range, and remains in the adjusted position after releasing.

Turning the lever out of the neutral "stop"-position in the other direction is only possible after unlocking a ring around the lever by lifting manually. After turning the lever, a micro switch is operated. Also, in this position, the lever remains in this position after releasing.

The change of resistance is linearly to the angular displacement of the lever.

To meet the specific proportions of the winch to be controlled, the linearity with the angular lever displacement changing resistance can be converted with the help of an optional Electronic Curve Converter, type ECC (see concerning brochure).

## Technical data/dimensions (mm)

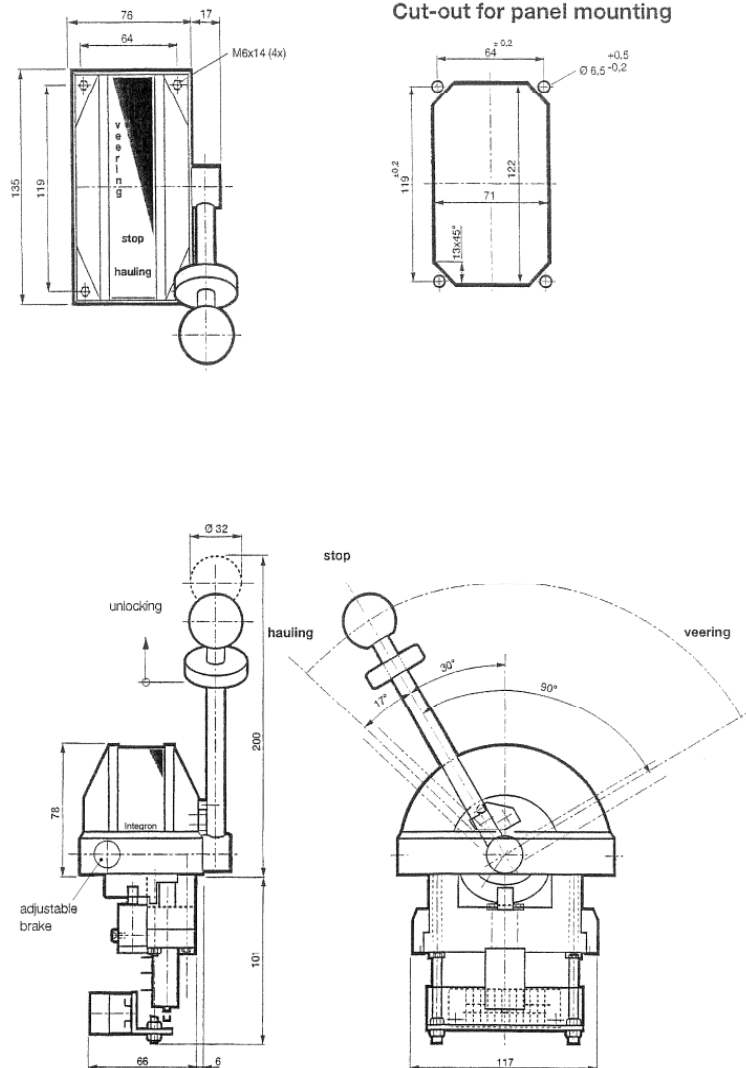

### Technical data

- Suitable for panel mounting
- Lever:
  - angular displacement out of the neutral "stop"-position:
    - in one direction max. 90° for adjusting the potentiometer
    - in the other direction 17° for operating the micro switch
  - location: right - **R**, left - **L**
  - unlocking by pulling up the ring around the lever
  - adjustable brake
- Potentiometer
  - resistance : 10kΩ +/- 10%
  - linearity : +/- 1%
  - max. powerrating : 2 W

- Micro switch:
  - switch voltage : max. 250 VAC/DC
  - current : max. 10A
  - contacts : 1 make/break
- Scale : with position indication
- Illumination : 2 bulbs 28V/2W
- Electrical connections : terminal block
- Protecting glass : IP 50
- Temperature range : -10° C up to +70° Celsius
- Special models : on request

Way of ordering : **Servo G** - **lever location**

Example: Servo G - **R**